

Applications

HSN fans are designed for transporting clean air. It has many applications in industry, where in technological processes need a small airflow and high pressure. Typical applications:

- supplying air to gas burner systems,
- filtration systems,
- air transport,
- air drying systems,
- cooling systems.

Construction

- high and very high-pressure, direct drive, radial fan,
- steel sheet rotor with backward inclined blades,
- steel welded housing,
- painted RAL 5010 (blue), corrosivity category C3,
- medium maximum temperature 80°C,
- ambient temperature of the motor from -30°C to +60°C (depending on model - see technical characteristic table),
- depending on the motor power, the fans are standard in two figures LG90 and LG270 (see specifications table),
- fans are standard in LG270 configuration.

Electric motor

- asynchronous, three-phase 230V/400V 50Hz or 400/690V 50Hz, efficiency class IE3,
- degree of protection IP55,
- insulation class F,
- three-phase motors are adapted for frequency converter.

Special executions

- optional configuration LG/RD,
- color other than standard and higher category of corrosivity,
- housing and support made of galvanized steel sheet, stainless steel 1.4301, acid-proof steel 1.4404,
- motor with voltage and frequency of power, degree of protection different than standard, equipped with sensors or additional cooling,
- sealing between the housing and the motor,
- HT version - maximum transported medium temperature higher than standard,
- ambient temperature range below -30°C and above +40°C,
- belt drive, clutch,
- ATEX version.

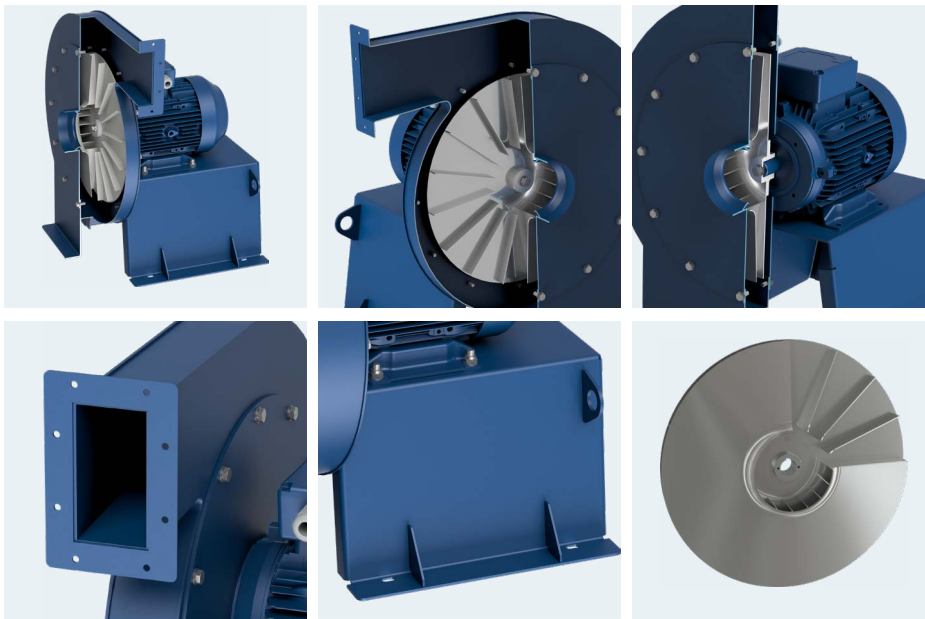

RELATED PRODUCTS

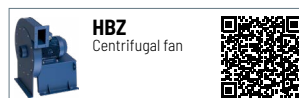
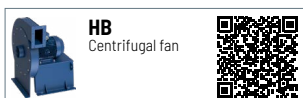



NOMINAL DATA

type	airflow max	pressure max	speed	voltage rated	current max abs.**	power motor	sound pressure level*	temp. operating min / max	temp. ambient min / max	weight	article number
2-POLE MOTORS 3000RPM											
HSN-2-40-075T	640 m ³ /h	3 200 Pa	2 890 rpm	400 V	1,7 A	0,75 kW	68 dB(A)	-30 / 80 °C	-30 / 60 °C	52,0 kg	436064020
HSN-2-40-110T	1 050 m ³ /h	3 200 Pa	2 890 rpm	400 V	2,5 A	1,1 kW	66 dB(A)	-30 / 80 °C	-30 / 60 °C	53,0 kg	436064021
HSN-2-40-150T	1 380 m ³ /h	3 200 Pa	2 880 rpm	400 V	3 A	1,5 kW	63 dB(A)	-30 / 80 °C	-30 / 40 °C	58,0 kg	436064022
HSN-2-45-110T	800 m ³ /h	3 890 Pa	2 890 rpm	400 V	2,5 A	1,1 kW	71 dB(A)	-30 / 80 °C	-30 / 60 °C	60,0 kg	436064520
HSN-2-45-150T	1 100 m ³ /h	3 890 Pa	2 925 rpm	400 V	3 A	1,5 kW	69 dB(A)	-30 / 80 °C	-30 / 40 °C	65,0 kg	436064521
HSN-2-45-220T	1 750 m ³ /h	3 890 Pa	2 910 rpm	400 V	4,3 A	2,2 kW	67 dB(A)	-30 / 80 °C	-30 / 40 °C	66,0 kg	436064522
HSN-2-45-300T	1 950 m ³ /h	3 890 Pa	2 880 rpm	400 V	5,3 A	3 kW	66 dB(A)	-30 / 80 °C	-30 / 40 °C	73,0 kg	436064523
HSN-2-50-220T	1 260 m ³ /h	4 800 Pa	2 910 rpm	400 V	4,3 A	2,2 kW	74 dB(A)	-30 / 80 °C	-30 / 40 °C	75,0 kg	436065020
HSN-2-50-300T	1 870 m ³ /h	4 800 Pa	2 915 rpm	400 V	5,3 A	3 kW	72 dB(A)	-30 / 80 °C	-30 / 40 °C	81,0 kg	436065021
HSN-2-50-400T	2 640 m ³ /h	4 800 Pa	2 895 rpm	400 V	7,3 A	4 kW	70 dB(A)	-30 / 80 °C	-30 / 40 °C	92,0 kg	436065022
HSN-2-56-400T	1 820 m ³ /h	6 020 Pa	2 895 rpm	400 V	7,3 A	4 kW	78 dB(A)	-30 / 80 °C	-30 / 40 °C	104,0 kg	436065620
HSN-2-56-550T	2 700 m ³ /h	6 020 Pa	2 940 rpm	400 V	10 A	5,5 kW	75 dB(A)	-30 / 80 °C	-30 / 40 °C	123,0 kg	436065621
HSN-2-56-750T	3 780 m ³ /h	6 020 Pa	2 930 rpm	400 V	13,3 A	7,5 kW	72 dB(A)	-30 / 80 °C	-30 / 40 °C	132,0 kg	436065622
HSN-2-63-750T	2 800 m ³ /h	7 620 Pa	2 930 rpm	400 V	13,3 A	7,5 kW	79 dB(A)	-30 / 80 °C	-30 / 40 °C	153,0 kg	436066320
HSN-2-63-1100T	4 400 m ³ /h	7 620 Pa	2 925 rpm	400 V	19,3 A	11 kW	78 dB(A)	-30 / 80 °C	-30 / 40 °C	212,0 kg	436066321
HSN-2-63-1500T	5 310 m ³ /h	7 620 Pa	2 940 rpm	400 V	26 A	15 kW	76 dB(A)	-30 / 80 °C	-30 / 40 °C	221,0 kg	436066322
HSN-2-71-1100T	2 900 m ³ /h	9 670 Pa	2 925 rpm	400 V	19,3 A	11 kW	85 dB(A)	-30 / 80 °C	-30 / 40 °C	233,0 kg	436067120
HSN-2-71-1500T	4 500 m ³ /h	9 670 Pa	2 940 rpm	400 V	26 A	15 kW	84 dB(A)	-30 / 80 °C	-30 / 40 °C	244,0 kg	436067121
HSN-2-71-1850T	5 650 m ³ /h	9 670 Pa	2 940 rpm	400 V	32,1 A	18,5 kW	81 dB(A)	-30 / 80 °C	-30 / 40 °C	251,0 kg	436067122
HSN-2-71-2200T	7 150 m ³ /h	9 670 Pa	2 950 rpm	400 V	38,1 A	22 kW	80 dB(A)	-30 / 80 °C	-30 / 40 °C	302,0 kg	436067123
HSN-2-80-2200T	4 800 m ³ /h	12 280 Pa	2 950 rpm	400 V	38,1 A	22 kW	89 dB(A)	-30 / 80 °C	-30 / 40 °C	327,0 kg	436068020
HSN-2-80-3000T	7 000 m ³ /h	12 280 Pa	2 965 rpm	400 V	53 A	30 kW	87 dB(A)	-30 / 80 °C	-30 / 40 °C	395,0 kg	436068021
HSN-2-80-3700T	9 000 m ³ /h	12 280 Pa	2 955 rpm	400 V	65 A	37 kW	85 dB(A)	-30 / 80 °C	-30 / 40 °C	410,0 kg	436068022
HSN-2-80-4500T	10 820 m ³ /h	12 280 Pa	2 960 rpm	400 V	77 A	45 kW	84 dB(A)	-30 / 80 °C	-30 / 40 °C	525,0 kg	436068023
HSN-2-90-3700T	6 500 m ³ /h	15 550 Pa	2 955 rpm	400 V	65 A	37 kW	93 dB(A)	-30 / 80 °C	-30 / 40 °C	454,0 kg	436069020
HSN-2-90-4500T	8 100 m ³ /h	15 550 Pa	2 960 rpm	400 V	77 A	45 kW	92 dB(A)	-30 / 80 °C	-30 / 40 °C	576,0 kg	436069021
HSN-2-90-5500T	10 400 m ³ /h	15 550 Pa	2 970 rpm	400 V	92 A	55 kW	90 dB(A)	-30 / 80 °C	-30 / 40 °C	611,0 kg	436069022
HSN-2-90-7500T	15 550 m ³ /h	15 550 Pa	2 960 rpm	400 V	127 A	75 kW	87 dB(A)	-30 / 80 °C	-30 / 40 °C	761,0 kg	436069023

* Measurement made at a distance of 1.5m from the outlet, for Q = 2/3 * Qmax

** the value of the rated current may vary depending on the manufacturer of the electric motor used.



PERFORMANCE CHARACTERISTICS OF THE FANS

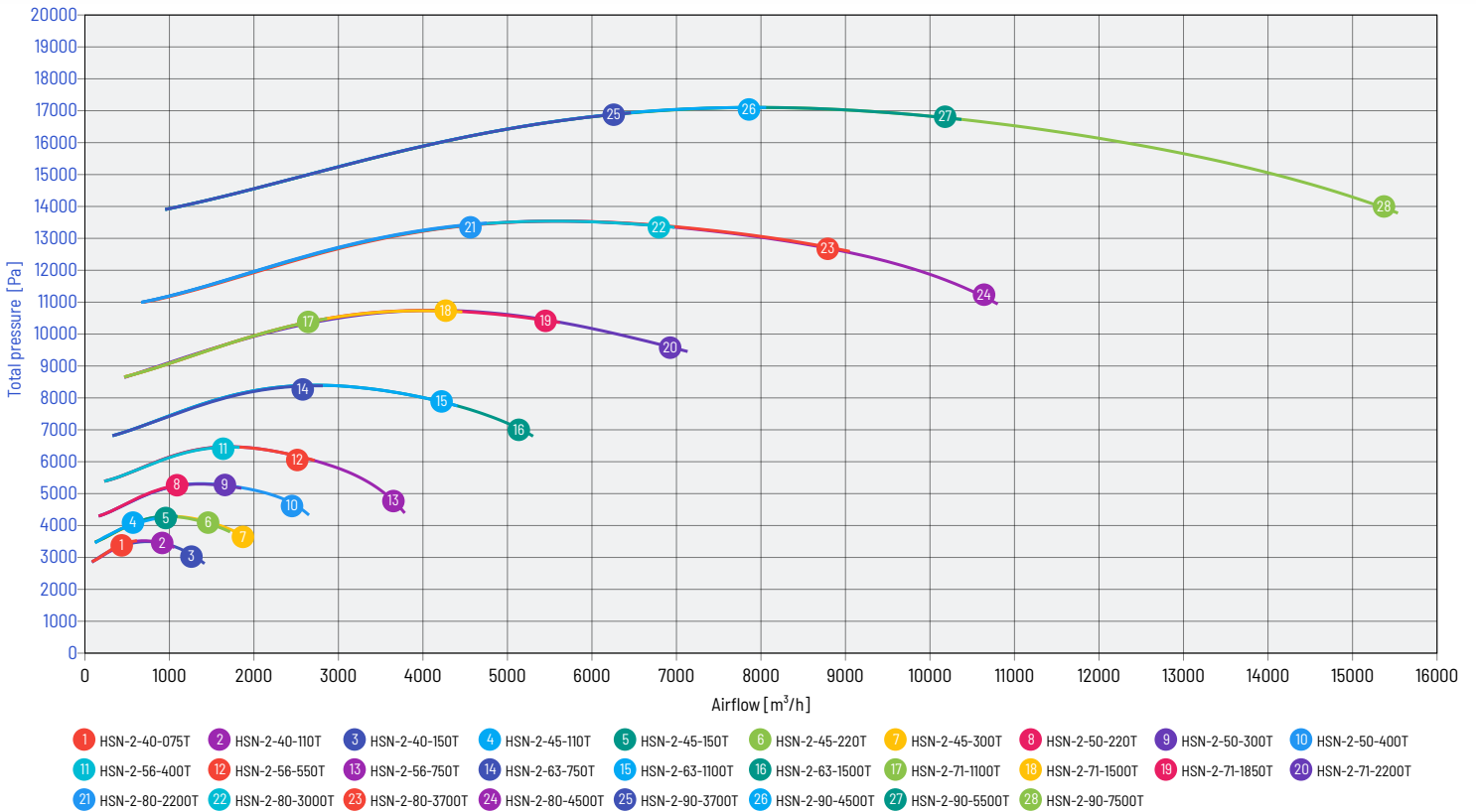

PERFORMANCE CHARACTERISTICS OF THE FANS

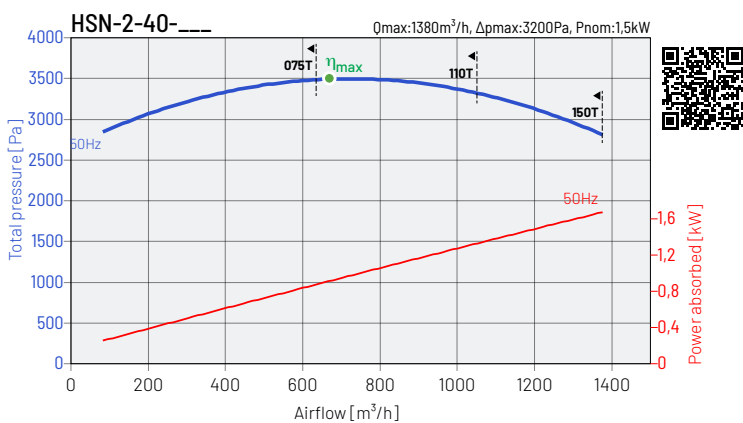

	MC	EC	SR	VSD	η %	N	kW	m³/h	Pa	rpm
075T	C	static	1	nie	56,6	63,2	0,93	656	2878	2890
110T	C	static	1	nie	57,3	63,9	0,92	656	2878	2890
150T	C	static	1	nie	58,1	64,8	0,90	656	2878	2880

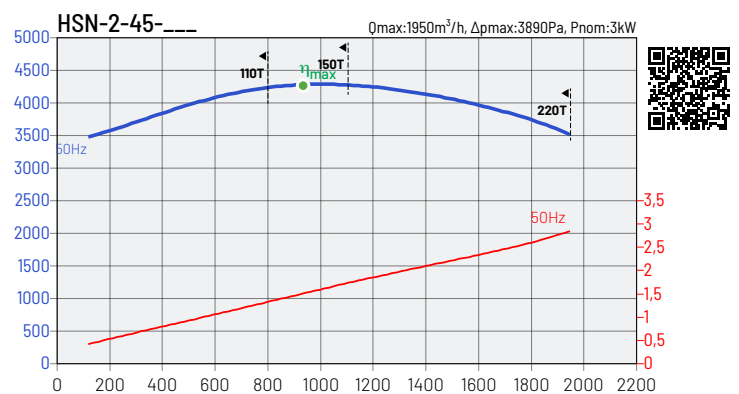

	MC	EC	SR	VSD	η %	N	kW	m³/h	Pa	rpm
110T	C	static	1	nie	57,0	62,1	1,58	934	3475	2890
150T	C	static	1	nie	57,8	62,9	1,56	934	3475	2925
220T	C	static	1	nie	59,0	64,2	1,53	934	3475	2910
300T	C	static	1	nie	59,8	65,0	1,51	934	3475	2880



PERFORMANCE CHARACTERISTICS OF THE FANS

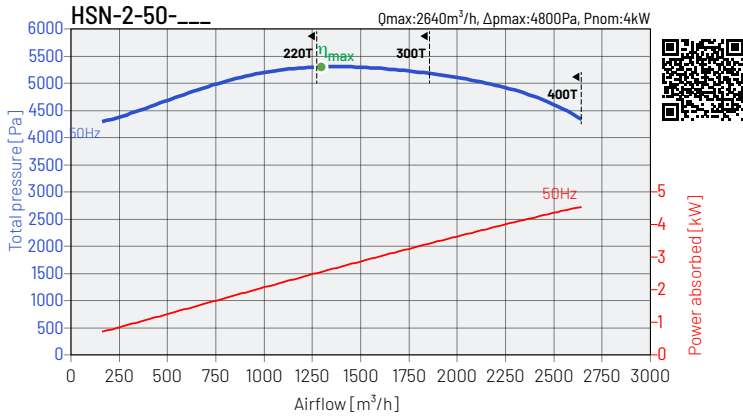

	MC	EC	SR	VSD	η %	N	kW	m ³ /h	Pa	rpm
220T	C	static	1	nie	59,0	62,8	2,59	1281	4292	2910
300T	C	static	1	nie	59,8	63,6	2,55	1281	4292	2915
400T	C	static	1	nie	60,5	64,3	2,52	1281	4292	2895

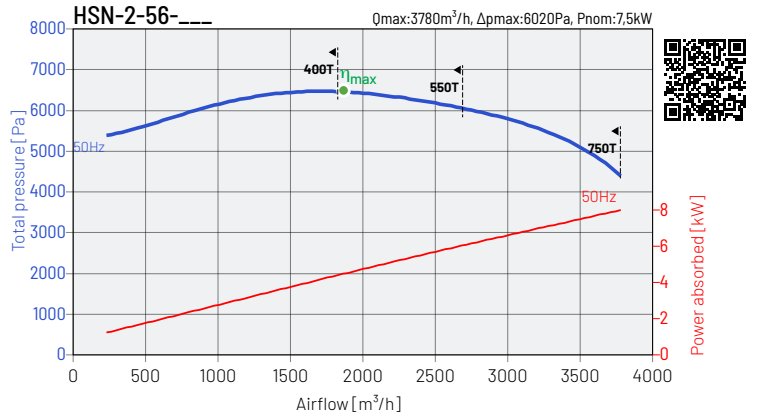

	MC	EC	SR	VSD	η %	N	kW	m ³ /h	Pa	rpm
400T	C	static	1	nie	61,6	63,8	4,45	1799	5481	2895
500T	C	static	1	nie	62,4	64,6	4,39	1799	5481	2940
750T	C	static	1	nie	63,0	65,3	4,35	1799	5481	2930

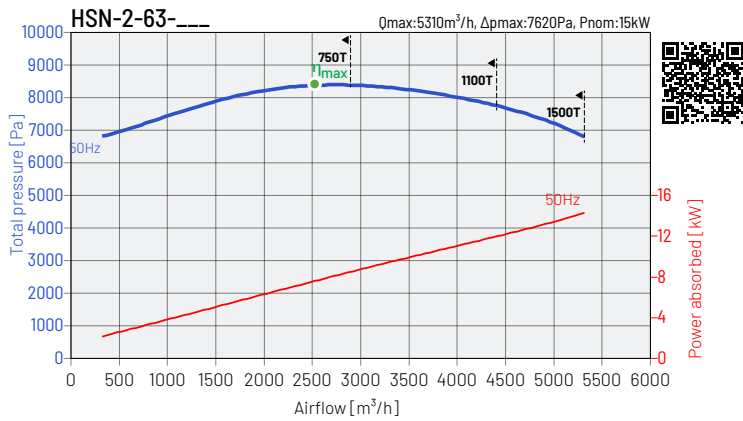

	MC	EC	SR	VSD	η %	N	kW	m ³ /h	Pa	rpm
750T	C	static	1	nie	61,8	62,5	7,84	2562	6810	2930
1100T	C	static	1	nie	62,6	63,3	7,74	2562	6810	2925
1500T	C	static	1	nie	63,1	63,8	7,68	2562	6810	2940

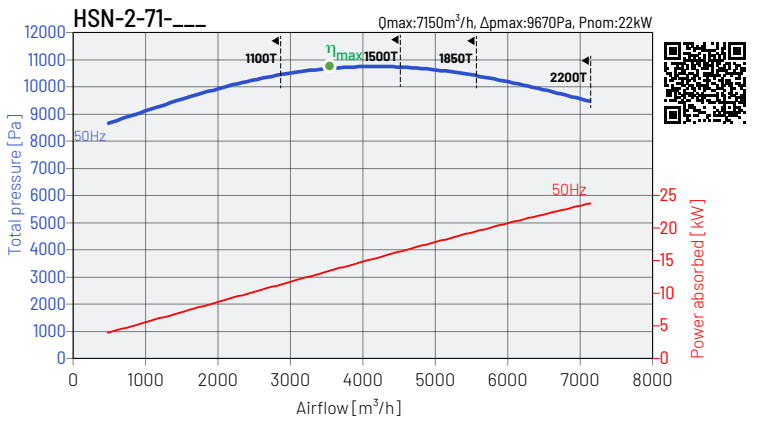

	MC	EC	SR	VSD	η %	N	kW	m ³ /h	Pa	rpm
1100T	C	static	1	nie	62,7	62,5	14,08	3667	8657	2925
1500T	C	static	1	nie	63,1	63,0	13,97	3667	8657	2940
1850T	C	static	1	nie	63,5	63,3	13,89	3667	8657	2940
2200T	C	static	1	nie	63,7	63,5	13,85	3667	8657	2950

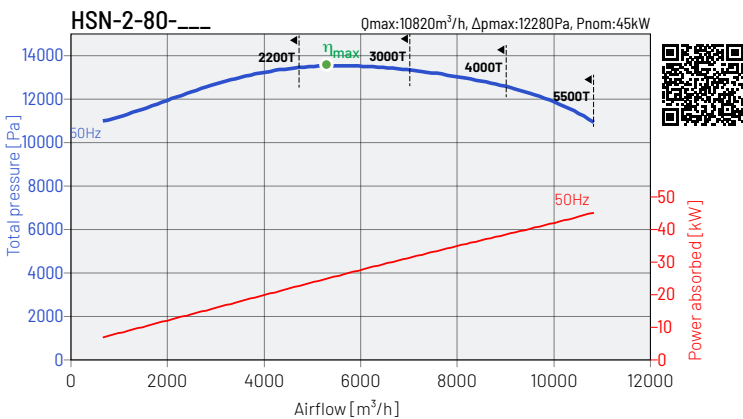

	MC	EC	SR	VSD	η %	N	kW	m ³ /h	Pa	rpm
2200T	C	static	1	nie	63,6	63,0	25,15	5246	10978	2950
3000T	C	static	1	nie	64,2	63,5	24,94	5246	10978	2965
3700T	C	static	1	nie	64,3	63,7	24,88	5246	10978	2955
4500T	C	static	1	nie	64,6	64,0	24,75	5246	10978	2960

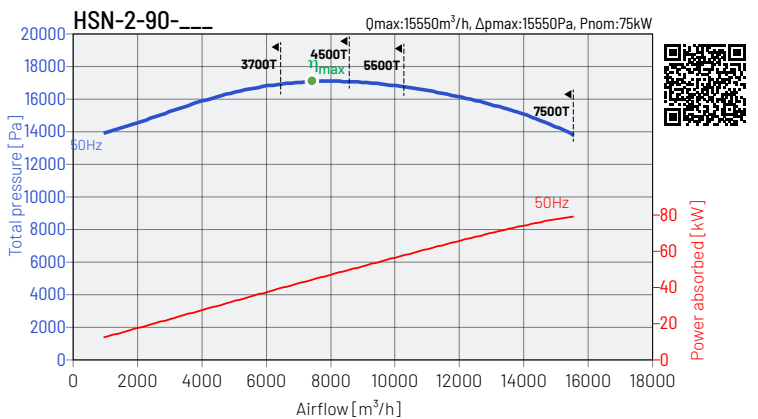

	MC	EC	SR	VSD	η %	N	kW	m ³ /h	Pa	rpm
3700T	C	static	1	nie	64,4	63,3	44,84	7469	13908	2955
4500T	C	static	1	nie	64,7	63,6	44,60	7469	13908	2960
5500T	C	static	1	nie	64,9	63,8	44,46	7469	13908	2970
7500T	C	static	1	nie	65,0	64,0	44,37	7469	13908	2960



DIMENSIONS

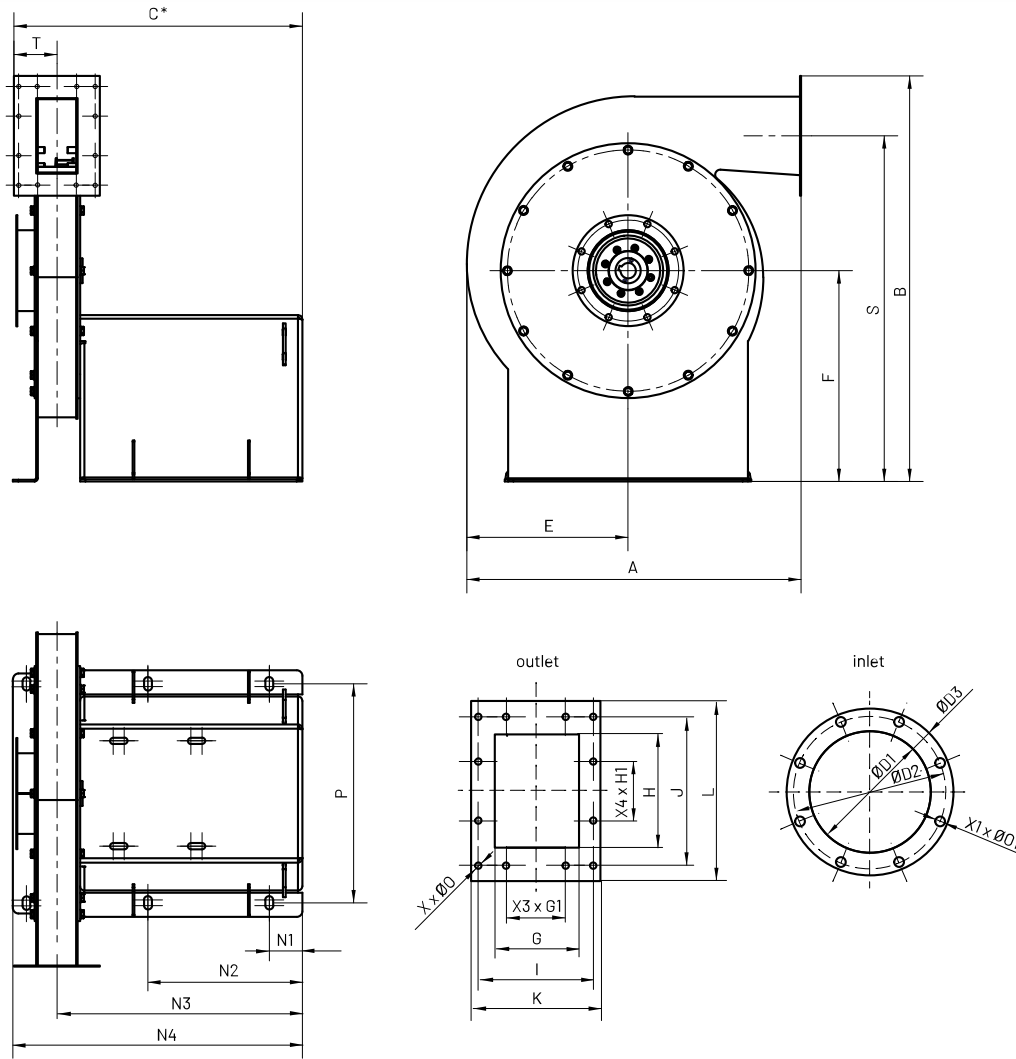

type	A mm	B mm	C* mm	ØD1 mm	ØD2 mm	ØD3 mm	E mm	F mm	G mm	H mm	I mm	J mm
HSN-2-40	603	731	520	140	182	200	291	380	69	132	138	178
HSN-2-45	678	770	528	160	200	220	326	380	77	148	138	178
HSN-2-50	754	814	532	180	219	240	362	390	85	165	138	198
HSN-2-56	837	840	544	200	241	260	405	380	108	185	138	218
HSN-2-63	937	964	544	225	265	290	455	450	108	208	138	238
HSN-2-71	1114	1076	551	250	292	310	512	500	118	235	138	262
HSN-2-80	1209	1261	700	280	332	360	577	600	137	264	178	318
HSN-2-90	1340	1478	838	315	366	390	648	750	155	297	198	318

* dimension for the longest motor version (depending on the motor manufacturer)

type	K mm	L mm	N1 mm	N2 mm	N3 mm	N4 mm	P mm	S mm	X1 x Ø01 mm	X3 x G1 mm	X4 x H1 mm	X x Ø0 mm
HSN-2-40	155	216	61	280	443	522	395	623	8x11,5	1x71	1x71	12x7
HSN-2-45	163	232	61	341	447	530	395	654	8x11,5	1x71	1x71	12x7
HSN-2-50	164	239	61	341	451	539	395	694	8x11,5	1x71	1x100	12x7
HSN-2-56	164	239	60	340	462	561	395	720	8x11,5	1x71	1x100	12x7
HSN-2-63	164	262	60	340	462	561	395	833	8x11,5	1x71	1x100	12x7
HSN-2-71	164	289	59	339	469	575	420	932	8x11,5	1x71	1x100	12x7
HSN-2-80	223	348	79	399	589	702	600	1087	8x11,5	1x71	1x125	12x10
HSN-2-90	221	361	106	526	681	834	740	1297	8x11,5	1x100	1x125	12x10



FIGURY

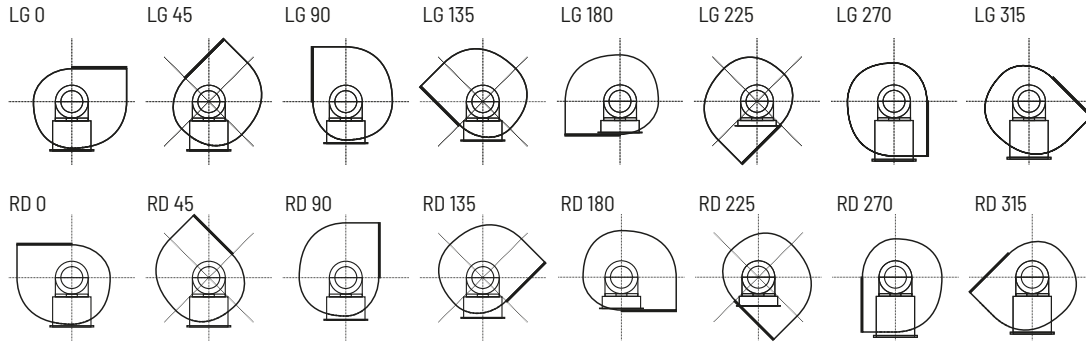

ELECTRICAL ACCESSORIES



type	inverter L	service switch	type	inverter L	service switch	type	inverter L	service switch
HSN-2-40-075T	L 0,75 kW	R-S 3-F + SP, 10A	HSN-2-56-400T	L 4,0 kW	R-S 3-F + SP, 10A	HSN-2-80-2200T	L 22,0 kW	R-S 3-F + SP, 40A
HSN-2-40-110T	L 1,5 kW	R-S 3-F + SP, 10A	HSN-2-56-550T	L 5,5 kW	R-S 3-F + SP, 16A	HSN-2-80-3000T	L 30,0 kW	R-S 3-F + SP, 63A
HSN-2-40-150T	L 1,5 kW	R-S 3-F + SP, 10A	HSN-2-56-750T	L 7,5 kW	R-S 3-F + SP, 16A	HSN-2-80-3700T	on request	on request
HSN-2-45-110T	L 1,5 kW	R-S 3-F + SP, 10A	HSN-2-63-750T	L 7,5 kW	R-S 3-F + SP, 16A	HSN-2-80-4500T	on request	on request
HSN-2-45-150T	L 1,5 kW	R-S 3-F + SP, 10A	HSN-2-63-1100T	L 11,0 kW	R-S 3-F + SP, 25A	HSN-2-90-3700T	on request	on request
HSN-2-45-220T	L 2,2 kW	R-S 3-F + SP, 10A	HSN-2-63-1500T	L 15,0 kW	R-S 3-F + SP, 40A	HSN-2-90-4500T	on request	on request
HSN-2-45-300T	L 4,0 kW	R-S 3-F + SP, 10A	HSN-2-71-1100T	L 11,0 kW	R-S 3-F + SP, 25A	HSN-2-90-5500T	on request	on request
HSN-2-50-220T	L 2,2 kW	R-S 3-F + SP, 10A	HSN-2-71-1500T	L 15,0 kW	R-S 3-F + SP, 40A	HSN-2-90-7500T	on request	on request
HSN-2-50-300T	L 4,0 kW	R-S 3-F + SP, 10A	HSN-2-71-1850T	L 18,5 kW	R-S 3-F + SP, 40A			
HSN-2-50-400T	L 4,0 kW	R-S 3-F + SP, 10A	HSN-2-71-2200T	L 22,0 kW	R-S 3-F + SP, 40A			

Article numbers

40016302	L 0.4kW	91040908-01	R-S 3-F + SP, 10A
40016312	L 0.75kW	91040908	R-S 3-F + SP, 16A
40016322	L 1.5kW	91040910	R-S 3-F + SP, 25A
40016332	L 2.2kW	91040924	R-S 3-F + SP, 40A
40016352	L 4.0kW	91040911-03	R-S 3-F + SP, 63A
40016362	L 5.5kW		
40016372	L 7.5kW		
40016383	L 11.0kW		
40016393	L 15.0kW		
40016412	L 18.5kW		
40016422	L 22.0kW		